

YAGI ANTENNE 16 dBd 1000 MM SCHAAAL 1:1

Oppervlakte cirkel (koperdraad) = πr^2

$\Pi = 3,1415$

$r^2 = ?$

Oppervlakte koperdraad = $2,5 \text{ mm}^2$

$2,5 \text{ mm}^2 / 3,1415 = 0,7958 \text{ x inv}^2 = 0,89$

$r^2 = 0,89$

$\varnothing \text{ koperdraad} = 2 \text{ x } 0,89 = \underline{1,78 \text{ mm}}$

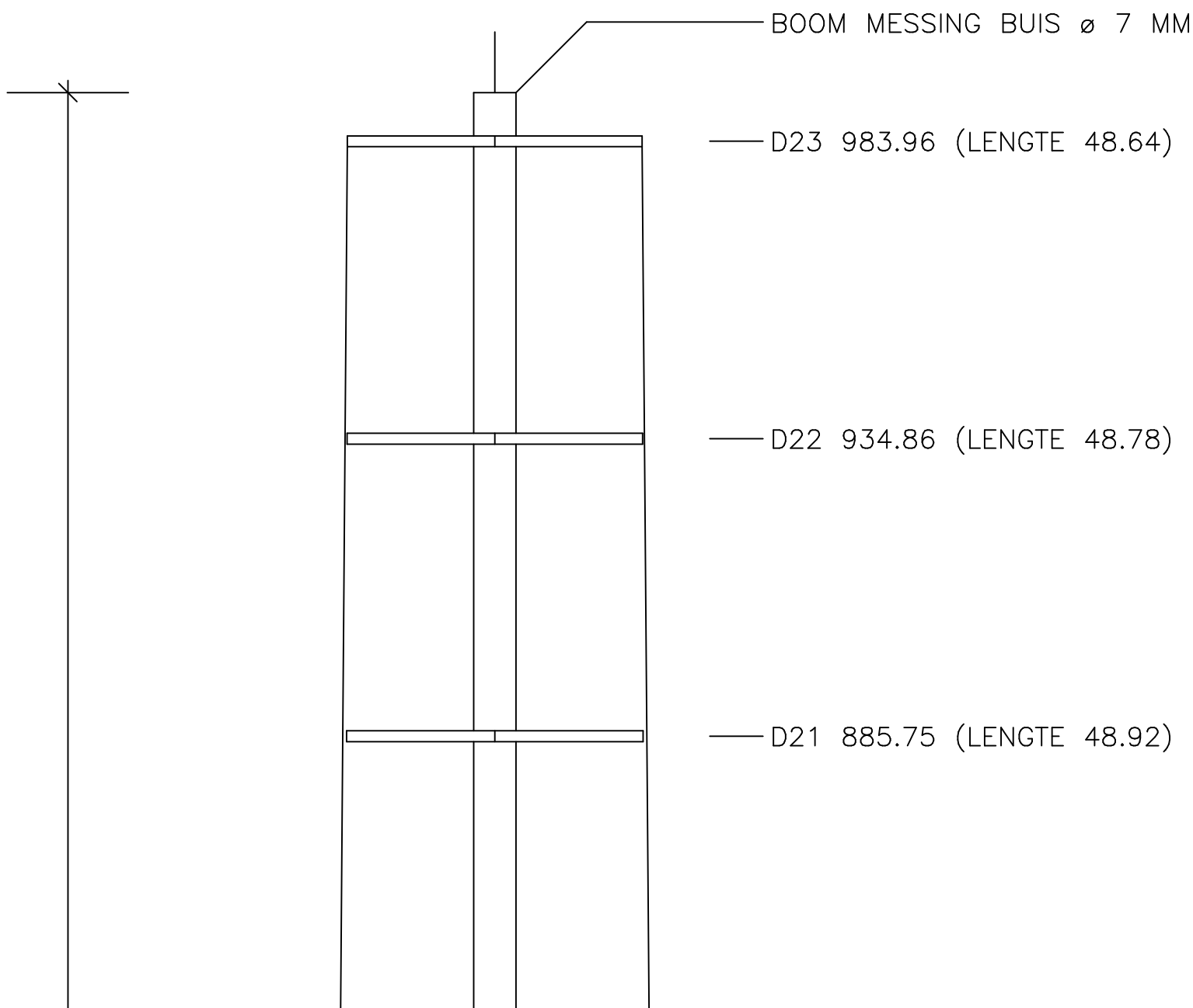
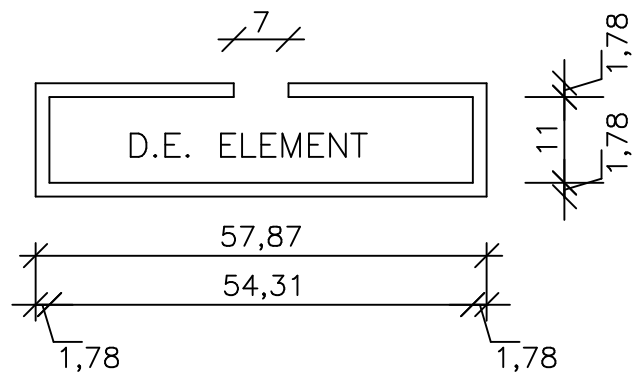

DEZE LIJN NA PRINTEN CONTROLEREN, DE BOOMLENGTE MOET EXACT 1000 MM ZIJN

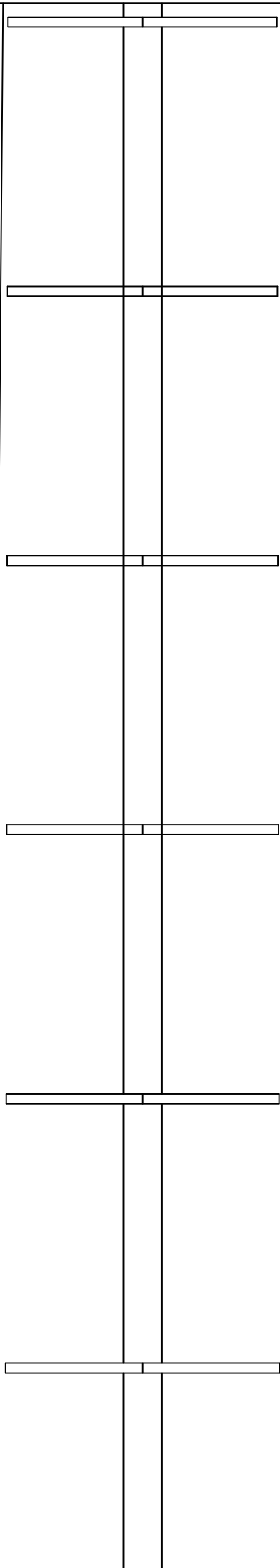

— D20 836.65 (LENGTE 49.08)

— D19 787.54 (LENGTE 49.24)

— D18 738.43 (LENGTE 49.4)

— D17 689.33 (LENGTE 49.58)

— D16 640.22 (LENGTE 49.77)

— D15 591.12 (LENGTE 49.97)

1000

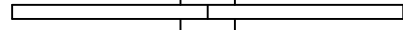

— D14 542.01 (LENGTE 50.19)

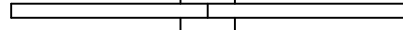

— D13 492.9 (LENGTE 50.42)

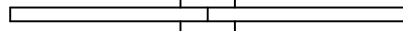

— D12 443.8 (LENGTE 50.67)

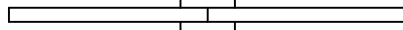

— D11 395.92 (LENGTE 50.94)

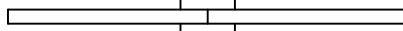

— D10 349.88 (LENGTE 51.24)

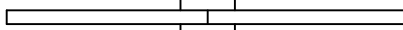

— D9 305.69 (LENGTE 51.57)

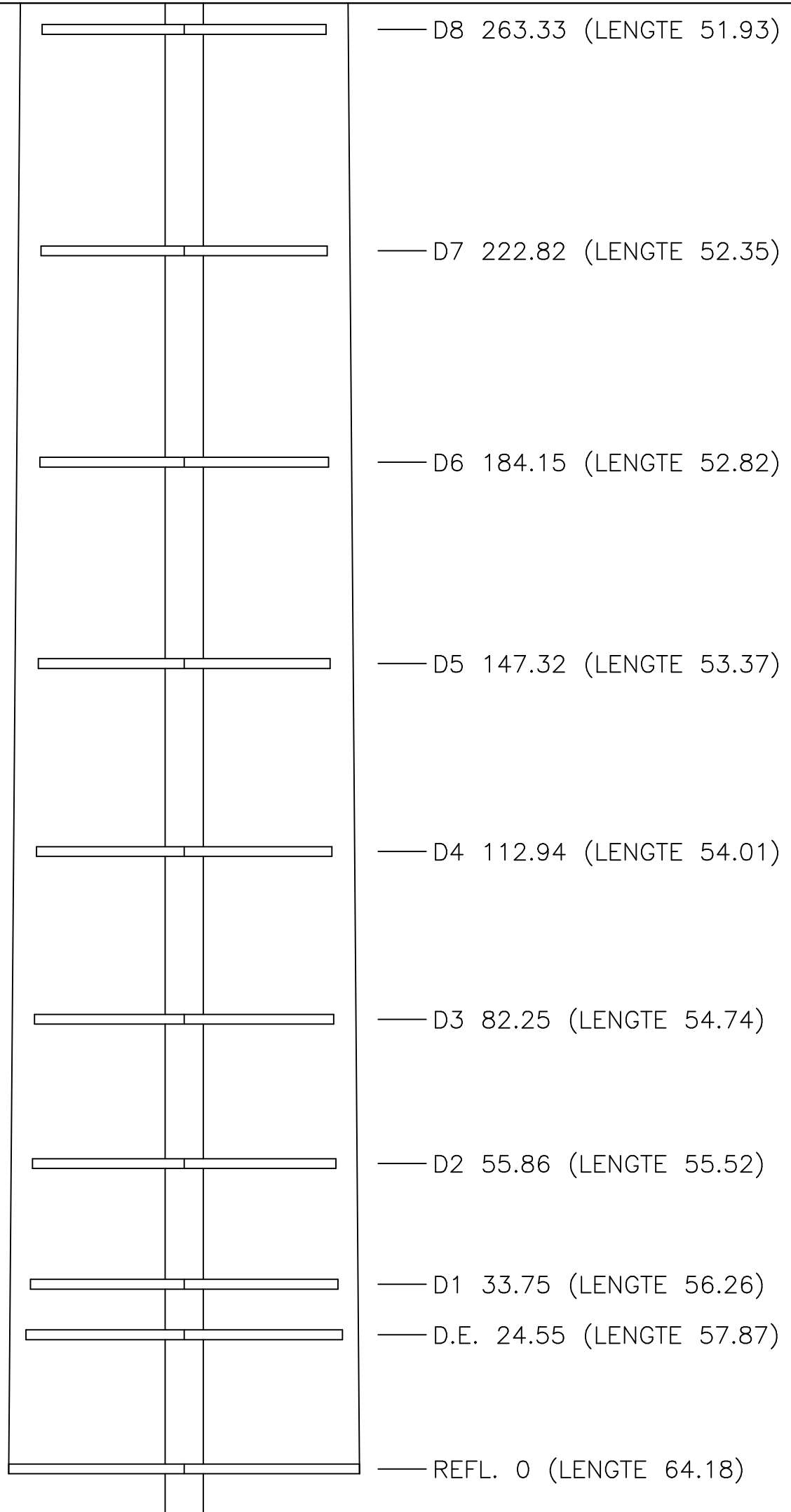

BOVEN AANZICHT